

George House's Land
formerly
Wm Edininston

Immer Knight
in Right of
Andrew Walker

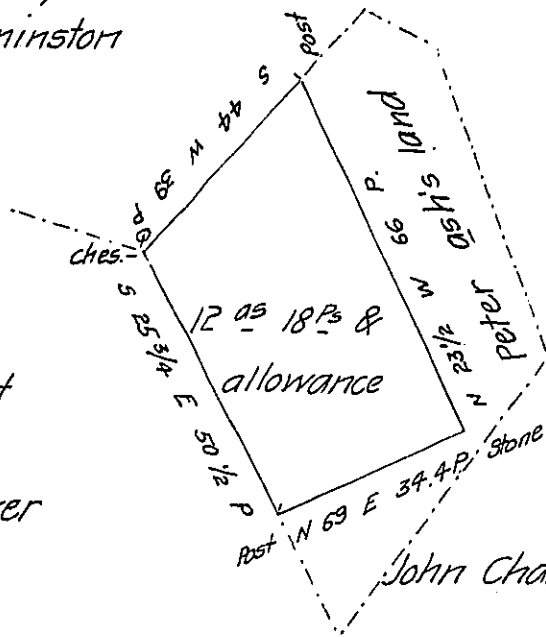

The above draught exhibits the Boundaries of a Tract of Land
situate in Lower Oxford Township Chester County containing Twelve acres &
eighteen perches and allowance of six per cent &c. being a part of a Tract of
24^{acs} 20^{ps} & allowance called Sandy Hill which was surveyed the 13th
of 4-Month 1767 ^{to Andrew Walker} on an Application No 1631 Dated 17th of June 1766

Surveyed February 21st 1814

Per

Arthur Andrews Jr. D.S.

Richard T. Leech Esq.

Surveyor General.

IN TESTIMONY that the above is a copy of the original remaining on file in
the Department of Internal Affairs of Pennsylvania, made
conformably to an Act of Assembly approved the 16th day of
February, 1833, I have hereunto set my Hand and caused
the Seal of said Department to be affixed at Harrisburg,
this sixth day of July 1905

Loael R. Brown
Secretary of Internal Affairs.